

CHUANGO®

CG-105S

On-Site Alarm System 

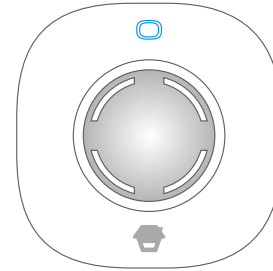

User Manual 

Table of Contents

Foreword	1
Features	2
In the Box	1~4
On-Site Alarm Panel	5~6

Alarm Panel Overview
Power On
Power Off

Testing and Installing Accessories 7~22

Remote Control
 Product Overview
 Arm(Away Arm)
 Disarm
 Home Mode (Stay)
 Mute Operation
 SOS
 Nightlight On/Off
Door/Window Contact
 Product Overview
 Test
 Installation



Pet-Immune PIR Motion Detector
 Product Overview
 Working Mode
 Test
 Installation
 Notices

Connecting and Deleting Accessories 23~25

Pairing the Remote Control
Pairing the Door/Window Contact
Pairing the Pet-Immune PIR Motion Detector
Deleting Accessories

Zone Setting For Wireless Accessories 26~27

Entry and Exit Delay 28

Act as an Accessories Kit 29~30

Pairing the Siren to the Control Panel
Pairing Other Wireless Detector to the Control Panel
Deleting the Siren from the Control Panel
Deleting Accessories from the Control Panel

Specifications 31~34



Foreword

Dear Customers:

Thank you for purchasing CG-105S. This product is a totally plug & play wireless home security solution. It features automatic pairing to various accessories, putting your home under all-round protection.

To experience this wonderful product, please follow the instructions in the user manual. If there is any problem when using the product, please contact us for help.



Features

100% wireless configuration, easy to use

Compact and streamline design

One-button pairing

Work as accessory or standalone alarm panel

Built-in battery for 8-hour standby

Mute operation

Support 40 wireless accessories (including remote control)

Built-in 1,000,000 RF codes combination maintains high reliability



Please read this manual carefully before using.



Please kindly keep this user manual for your reference when necessary.

In the Box

WS-105 Alarm Panel x 1

The alarm panel receives and processes signals from wireless accessories. When the accessory is triggered, the panel will alarm and the strobe light will flash to deter intruders. With plug-in design, it is powered by AC 100~240V by plugging it into a wall outlet.

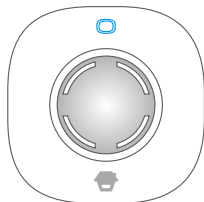

PIR-910 Pet-Immune PIR Motion Detector x 1

The wireless PIR Motion Detector is an intelligent passive infrared motion sensor, designed to detect human movements within an approximate range of 0 to 8 meters from the detector. The detector includes fuzzy logic to minimize false alarms from unwanted heat sources. With power saving feature, the detector will enter sleeping mode after the second activation within 3 minutes to save power. The detector features pet immunity for small animals up to 25kgs.

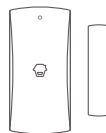
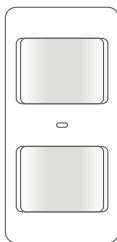

DWC-102 Wireless Door/Window Contact x 1

The door/window contact can be installed on doors, windows and any other objects that open and close. The sensor transmits signals to the control panel when a magnet mounted near the sensor is moved away.



RC-80 Wireless Remote Control x 2

The remote control is compact and portable; it is convenient to carry it to arm, disarm, part arm the alarm system and also make an emergency call.

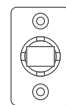

Bracket for PIR Motion Detector x 1

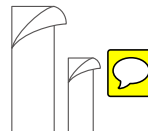

Double-sided Tape for Door/Window Contact x 2



User Manual x 1



Screws and Wall Plugs x 2

On-Site Alarm Panel

Alarm Panel Overview

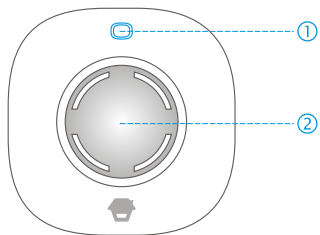

① Power button/connect button ② Strobe light

Siren and Strobe Light

Status	Siren	Strobe Light
Arm or Home Arm	Beeps once	Flashes once and then on
Disarm	Beeps twice	Flashes twice and then off
Mute Arm	No beep	Lights on
Mute Disarm	No beep	Lights off



Power On



The siren is powered off by default. Plug the siren into a power outlet. Press the power button. It beeps once, indicating power is on.

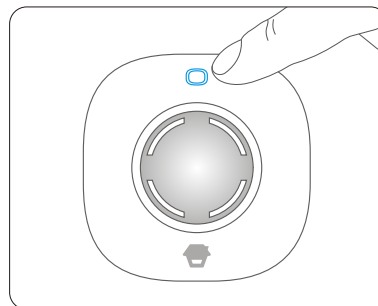

Power Off

After the siren is powered on, press the power button once. Then, press and hold the power button for 6 seconds until a beep is heard, indicating power is off.



Testing and Installing Accessories

Remote Control

Product Overview

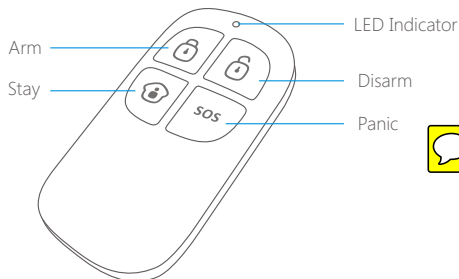



Arm (Away Arm)

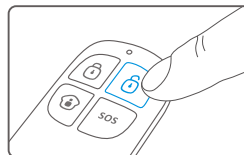

Press the **[Arm **] button. The siren beeps once, indicating the system is armed.

Disarm



Press the **[Disarm **] button. The siren beeps twice, indicating the system is disarmed.

Home Mode (Stay)



Press the **[Stay **] button, 3 seconds later, the siren beeps once, indicating the system is in home mode.

When the whole system is in home mode, all the detectors in normal zone are armed except those in home mode zone, while the home mode detectors are in disarmed status, users can move freely within the range of the disarmed area.

Note: Home mode requires the zone setting on detectors. For more details please refer to page 26-27.

Mute Operation

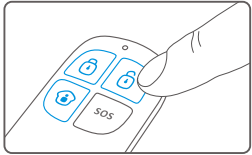

Press and hold the **[Stay 🏠]** button for 1 second, then press the **[Arm 🔒]** button within 3 seconds. The system is armed silently.
Press and hold the **[Stay 🏠]** button for 1 second, then press the **[Disarm 📵]** button within 3 seconds. The system is disarmed

SOS



SOS

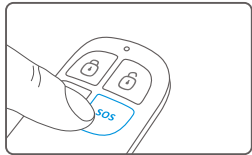

Press the **[SOS]** button on the remote control, the system will alarm immediately.



Nightlight On/Off

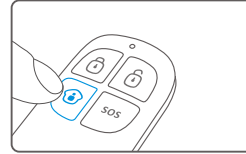

Press the **[Stay 🏠]** button twice, the siren switches to home mode silently and the nightlight is on.

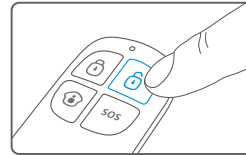

Press the **[Disarm 📵]** button twice, the siren disarms and switches off the nightlight.



Door/Window Contact



Product Overview

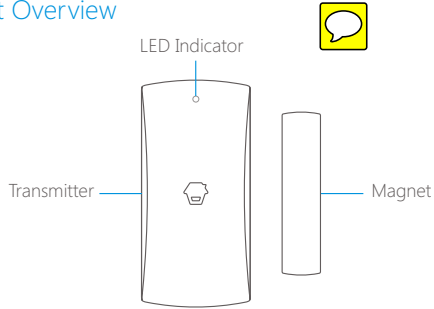

LED Indication



Status	Meaning
Blinks once	Door/window contact is triggered
Blinks once every 3 seconds	Low power indication, please replace battery immediately

PCB Layout

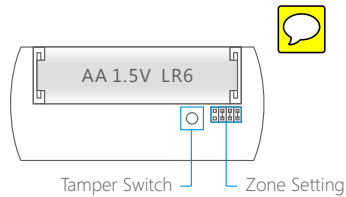

Test

This is to test whether the contact can work properly.

① Remove the insulating strip

Remove the insulating strip, the contact works immediately.

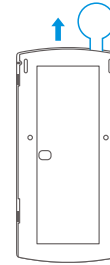

② Pay attention to the direction

There are triangle marks on the side of the transmitter and magnet. Make sure the triangle marks face each other and within the range of 1 cm.

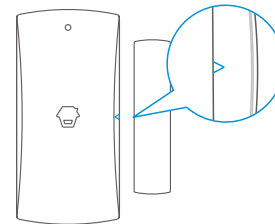

③ Test the contact

Press the [Arm] button. The system switches to armed status. Separate the transmitter and magnet within the space more than 2 cm. If an alarm is triggered at once, that means the sensor is working properly.

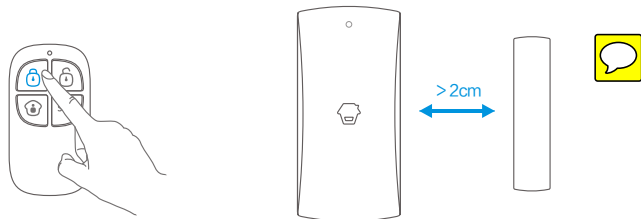

Installation



Make sure the contact works properly before installing it. There are triangle marks on the side of the transmitter and magnet. Make sure the triangle marks close to each other and within the range of 1 cm. As long as the space between the transmitter and magnet is over 2 cm and the LED on the transmitter is on.

Secure the Contact with Double-sided Tapes

Secure the transmitter and magnet on desired locations with double-sided tapes.

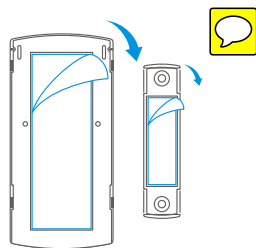

Secure the Contact with Screws

① Remove the rear cover

Press the rear cover and slide down to remove the rear cover.

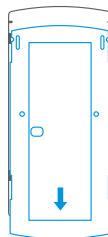

② Choose a suitable install location

Choose a suitable location on the door or window.

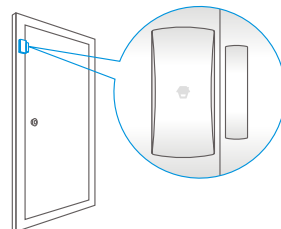

③ Tighten the screws

Follow the [UP] sign. Put the screws through the tiny holes. Then, tighten screws.

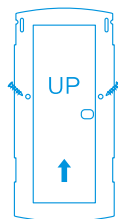

④ Close the rear cover

Slide the transmitter down until it secures. Then, align the transmitter and magnet.

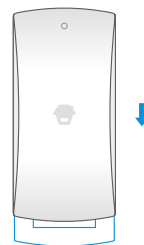

Note: Make sure the transmitter and magnet works properly on the desired locations. If a metal door is installed, place spacers under the transmitter and magnet. Do not apply the contact to a rolling shutter. Purchase dedicated contacts for rolling shutters when necessary.

Pet-Immune PIR Motion Detector

Product Overview

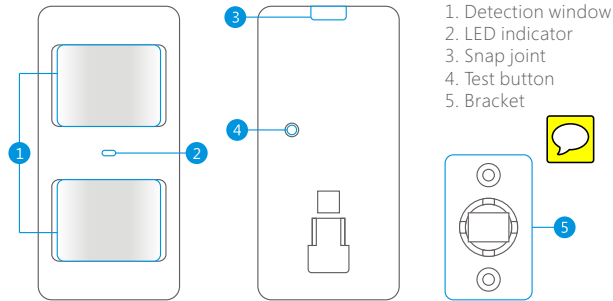

LED Indication

LED Status	Meaning
Blinks continuously	Self-testing
Blinks once	Intrusion is detected
Blinks twice	Testing mode is finished, enters power saving mode
Blinks once per 3 seconds	Low battery. Please replace the batteries immediately

PCB Layout

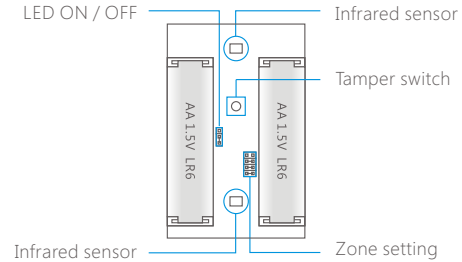

Working Mode

Testing Mode

After self-testing, press the test button, the detector switches to the testing mode and detects once every 10 seconds. After 3 minutes, the LED blinks twice, and the detector switches to the power saving mode.

Hold the test button and load the battery, then release the test button, the detector stands in testing mode, it keeps detecting once every 10 seconds. Exit this state by reloading the battery without holding the test button.

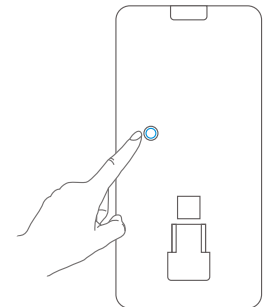

Power Saving Mode



The product is featured with power saving mode. If the detector detects human body movement twice within 3 minutes, it will switch to sleeping state to save power. At this time, the LED will not blink and would not trigger an alarm. After no movement within the next 3 minutes, the detector switches back to working status automatically.

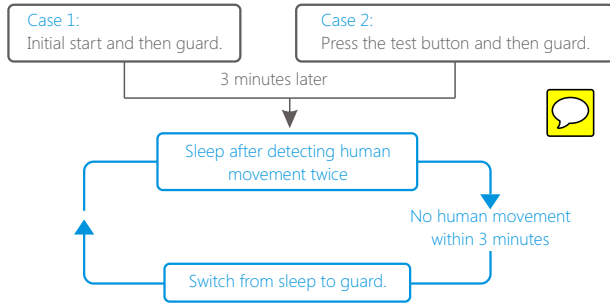

Note: when the detector is in the sleeping state, make sure there is no human body movement within 3 minutes, otherwise the detector remains asleep.

In sleeping state, it is recommended that you leave the room after arming the system, ensure no human body movement within 3 minutes, and then come back to the room, the siren will sound immediately.

Detection Scope

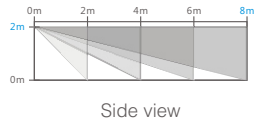
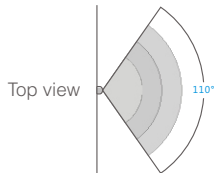

Test



This is to test whether the PIR detector works properly.

① Remove the insulating strip

Press the snap joint to open the rear cover. Then, remove the insulating strip.

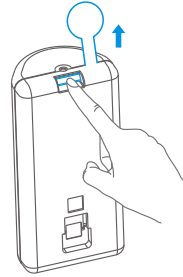

② Arm the system

Press the [Arm] button on the remote control. The system is in arm state.



③ Trigger an alarm

Keep pressing the test button at the back until the siren sounds. It indicates that the PIR motion detector has been paired to the siren.

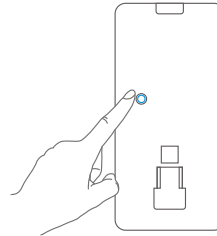

Installation



After making sure the detector works properly, do as follows:

① Choose a suitable installation location

For installation notices, please see page 21~22.

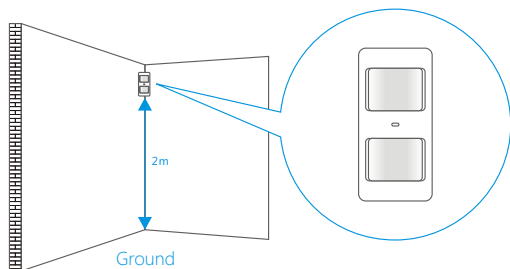

② Fix the detector

Fix the installation bracket on the wall with screws, and then fit the groove at the back of the detector on the bracket.

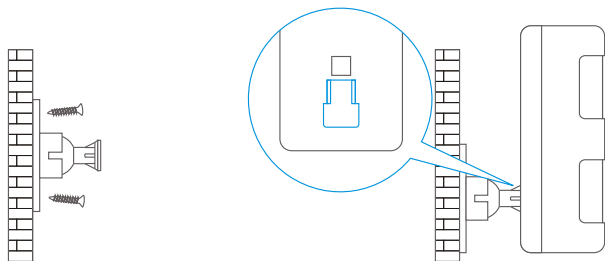

③ Test the PIR motion detector

Press the test button. It switches to the testing mode that lasts for 3 minutes. Walk in the detection scope and observe the LED indicator. When any human body movement is detected, the LED blinks once.

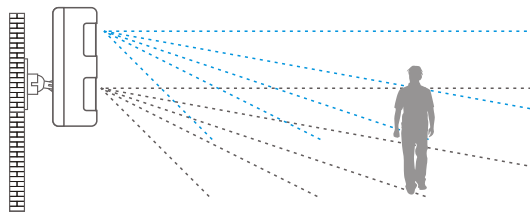

④ Adjust the angle

Adjust the bracket angle to achieve the best detection effect.

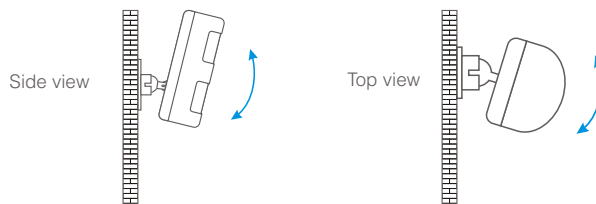

Note! If pet-immune function is applied, please do not adjust the angle up or down, but keep it parallel with the wall.

Notices



Pay attention to the following during installation:

Choose a proper location



It is recommended to mount it at the height of 2m from the ground. The detector aims at preventing intrusion. Detecting human body movement at the entry or exit is critical for security.

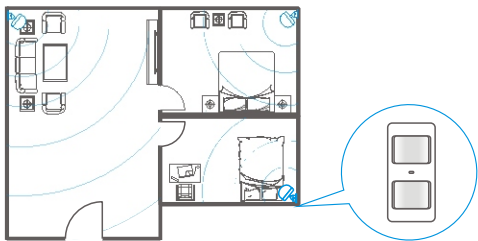

Mount the detector in a proper angle



The installation angle affects sensitivity directly. The sensitivity is optimal when the walk direction is vertical to the infrared direction. Choose the best location and angle according to the actual situation and detection scope diagram.

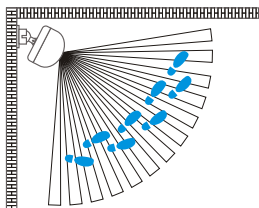

Avoid facing to glass doors or windows

Strong light interferes with detection sensitivity. In addition, complicated situations outside the door or window, such as traffic flow, stream of people, also should be avoided.

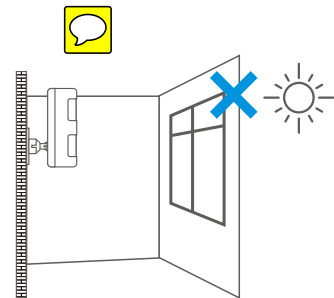

Avoid facing to or positioning close to heat/cold sources

Heat/cold sources, such as heat extraction units, heaters, air conditioner, microwave oven, refrigerator, may cause false triggering, should be avoided.

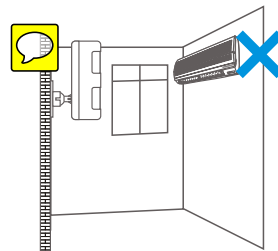

Avoid facing to swinging objects

Swinging objects may also trigger false alarm. Besides, if there are two detectors covering the same scope, adjust the locations to prevent cross-interference.

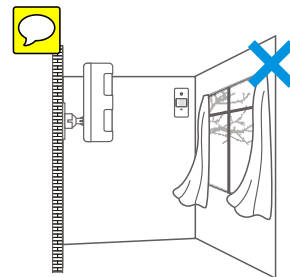

Connecting and Deleting Accessories



Accessories need to be paired to the siren so that the siren can receive signals from them, and sound the alarm. Accessories in the kit have been paired to the siren before delivery, and ready for use. If the siren does not alarm when detectors are triggered, please pair them again. Accessories purchased separately must be paired to the siren before use.



Pairing the Remote Control



① Press the connect button on the siren

Press the connect button on the siren, it beeps once, 3 seconds later, it beeps once again and the strobe flashes, indicating the siren is ready for pairing.

② Press any button on the remote control

Press any button on the remote control, the siren beeps once, indicating successful pairing.



Note: If the siren beeps twice, it indicates the remote control has been paired before.

Pairing the Door/Window Contact



① Press the connect button on the siren

Press the connect button on the siren, it beeps once, 3 seconds later, it beeps once again and the strobe flashes, indicating the siren is ready for pairing.

② Separate the transmitter and magnet

Make sure the triangle marks close to each other and within the range of 1cm, and then separate them with the space more than 2 cm. The siren beeps once indicates successful pairing.

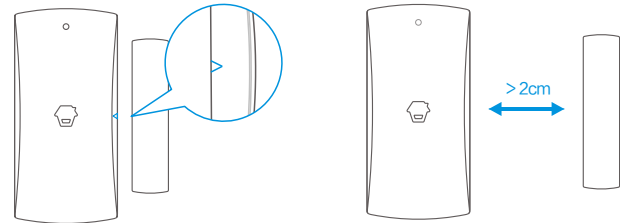

Note: If the siren beeps twice, it indicates the door/window contact has been paired before.



Pairing the PIR Motion Detector



① Press the connect button on the siren

Press the connect button on the siren, it beeps once, 3 seconds later, it beeps once again and the strobe flashes, indicating the siren is ready for pairing.

② Press the test button on the PIR motion detector

Press the test button at the back of the PIR motion detector. The siren beeps once, indicating successful pairing.

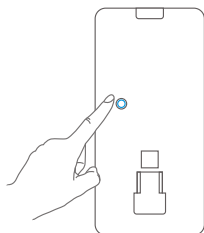

Note: If the siren beeps twice, it indicates the PIR motion detector has been paired before.



Deleting Accessories



Deleting accessories is to disconnect accessories from the siren. After that, the siren cannot receive signals from accessories nor trigger alarms.

Press and hold the connect button on the siren for 6 seconds, the siren beeps once and the strobe flashes twice, indicating all the accessories are deleted.



Zone Setting For Wireless Accessories

You can set zones by changing the jumpers in detectors. After the setting, detectors can work in corresponding modes. It must be paired to the siren again.

Zones include normal zone, home mode zone, single delay zone and 24-H zone.

The detailed operations are as follows:

Remove the rear cover of a door/window contact or PIR motion detector. Set the jumpers accordingly. Pay attention to the order of D0-D3.

Normal zone: In arm or home mode state, the siren will sound immediately when the detectors set to normal zone is triggered.

Home mode zone: In home mode state, the siren will not sound when the detectors set to home mode zone is triggered.

Single delay zone: Alarms will be delayed according to the set delay time. You can set one or more detectors to single delay zone. Generally, it is applies to the door/window contact at the entrance. For example, if you do not want carry the remote control, set the door/window contact to single delay zone and set the delay time to 30 seconds. After you enter home, the system in the arm state will alarm 30 seconds later. The siren beeps once every 5 seconds, reminding you to disarm the system.

24-H zone: In any condition, the system will alarm immediately once the 24-H zone detector is triggered.

How to set:



Open the rear cover of the detector, change the array of jumpers to the corresponding position as below (Mind the direction of D0-D3):

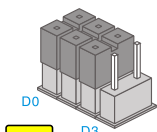

Normal Zone

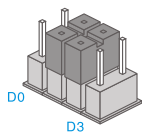

Home Mode Zone

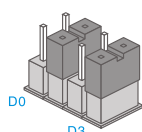

Single Delay Zone

Note: The default zone setting for PIR motion detector is home mode zone. The default zone setting for door/window contact is normal zone.



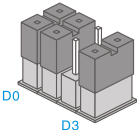

24-H Zone

Note: It is recommended to set smoke detector, gas detector or outdoor beam sensors at 24-H zone which offer full-day detection.



Entry and Exit Delay



The detectors should be set in single delay zone before using this function.

Exit Delay (Arm Delay)



The whole alarm system enters armed status after the delay time.

Entry Delay (Alarm Delay)



When the detectors which have been set to single delay zone are triggered, siren will alarm after the delay time. If the detectors that set to normal zone or home mode zone are triggered, siren will alarm immediately.

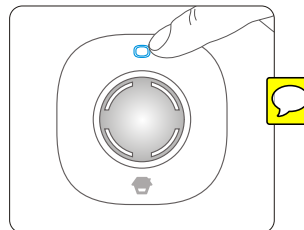

Press the connect button twice, delaying for 15 seconds.
Press the connect button for three times, delaying for 30 seconds.
Press the connect button for four times, disabling the function.

Note: Press the [Arm] button on the remote control twice. The system switches to armed status immediately.

About single delay zone, please refer to page 26.

Act as an Accessory Kit

If user purchased our alarm system before, CG-105S can act as an accessory kit, working with the control panel after successful pairing.

Pairing the Siren to the Control Panel

Press the Connect Button on the Siren

Press the connect button on the siren, it beeps once, 3 seconds later, it beeps once again and the strobe flashes, indicating the siren is ready for pairing.

Press the [Arm] or [SOS] Button on the Control Panel

Press the **[Arm]** or **[SOS]** button on the control panel, the siren beeps once, indicating successful pairing.

Exit the Pairing Status

Press the connect button on the siren, it beeps once, exiting the pairing status.

Test Whether the Siren has been paired

Press the **[Arm]** button on the remote control. If the siren and control panel both beep once, it indicates the pairing succeeds. If not, please pair them again.

Pairing Other Wireless Detectors to the Control Panel

After control panel enters its pairing status (please refer to its user manual), trigger the wireless detector, the control panel beeps once to indicate successfully pairing.

Deleting the Siren from the Control Panel

Press and hold the connect button on the siren for 6 seconds. The siren beeps once and the strobe flashes twice. All accessories are deleted.

Deleting Accessories from the Control Panel

Please refer to the manual of control panel.

Specifications



On-Site Alarm Panel

Item No.: WS-105

Power Supply

AC 100~240V, 50/60Hz

Backup Battery

3.7V 600mAh lithium battery

Volume

90dB

Static Current

≤ 13mA

Alarm Current

≤ 100mA

Radio Frequency

315MHz or 433.92MHz (±75KHz)

Housing

PC+ABS plastic

Operating condition

Temperature -10°C~+55°C

Relative Humidity ≤ 80% (non-condensing)

Dimensions (L×W×H)

90 x 90 x 42.2mm (Not include the plug part)

Wireless Remote Control

Item No.: RC-80



Power Supply

DC 3V (CR2025 lithium battery x 1pc)

Transmitting Current

≤ 7mA

Transmitting Distance

≤ 80m (in open area)

Radio Frequency

315MHz or 433.92MHz (± 75KHz)

Housing Material

ABS plastic

Operating Condition

Temperature -10°C ~ +55°C

Relative Humidity ≤80% (non-condensing)

Dimensions (L x W x H)

58 x 31 x 9.5mm



Wireless Door/Window Contact

Item No.: DWC-102

Power Supply

DC 1.5V (AA 1.5V LR6 Battery x 1pc)

Static Current

≤ 35uA

Alarm Current

≤ 40mA

Transmitting Distance

≤ 80m (in open area)

Radio Frequency

315MHz or 433.92MHz (±75KHz)

Housing Material

ABS plastic

Operating Condition

Temperature -10°C ~ +55°C

Relative Humidity ≤80% (non-condensing)

Transmitter Dimensions (L x W x H)

71 x 34 x 17.5mm

Magnet Dimensions (L x W x H)

51 x 12 x 13.5mm

Pet-Immune PIR Motion Detector

Item No.: PIR-910



Power Supply

DC 3V (AA 1.5V LR6 Battery x 2 pcs)

Static Current

≤ 90uA

Alarm Current

≤ 9.5mA

Detection Scope

8m/110°

Transmitting Distance

≤ 80m (in open area)

Radio Frequency

315MHz or 433.92MHz (± 75KHz)

Housing Material

ABS plastic

Operating Condition

Temperature -10°C ~ +55°C

Relative Humidity ≤80% (non-condensing)

Detector Dimensions (L x W x H)

108 x 52 x 36.8 mm

Bracket Dimensions (L x W x H)

52 x 30 x 26.5 mm

CHUANGO®

产品型号	WS-105	部件名称	说明书
设计	林寿	材料	80克书写纸
印刷尺寸	210X142mm	成品尺寸	105X142mm
工艺	骑马钉-40P	版本	PA: CG-105S-UM-EN-V1.0

注:
双色、双面印刷